

# Stratford General Hospital Foundation Monitor



**CHEMO TOUR HERE!**



**PHARMACY TOUR HERE!**



*In Our Hands*

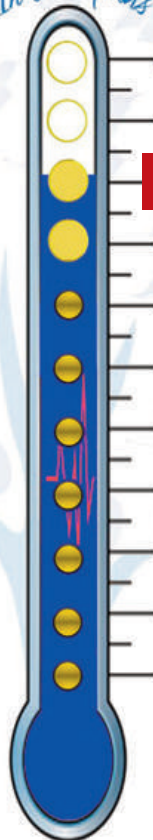

30 Million!

**\$26.4 million**



# PROJECT TIMELINE UPDATE

## Cancer Care & Ambulatory Clinic & Co-

Nov 2002 – Chemotherapy Opening



The opening of our Chemotherapy Unit in our West Building, 3rd Floor North Wing.

Nov 2012 – Chemo 10th year anniversary



Spring 2023 – Construction begins



Summer 2024 – in our new space continuing to provide top-notch care

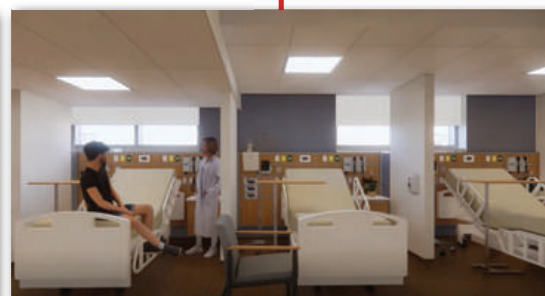
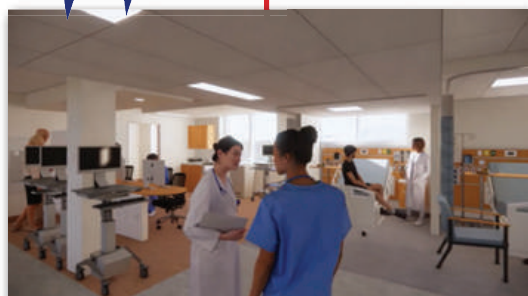

Cancer Care & Ambulatory Clinic



The SGH Foundation is thrilled for what is coming our way in the Summer of 2024 and we wish to share this excitement with you all...

This timeline will give you a first-hand summary of the redevelopment of our current Cancer Clinic and our Pharmacy Department.

# located Pharmacy

Sept 2021 – Wall Smashing Event – demolition began

2021



Jan 2023 – Signing of the contract

2023



GOAL

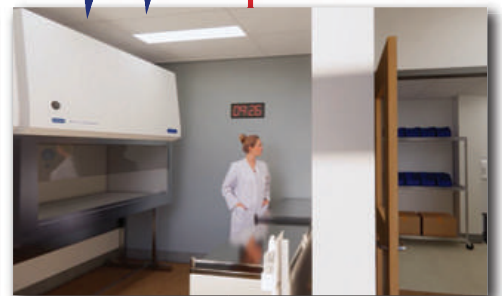
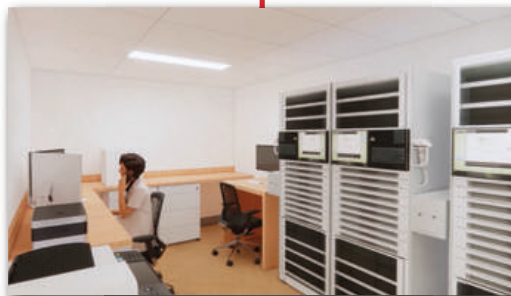

Co-located Pharmacy

***Tour the units  
using one of these QR codes!***

### **CHEMO TOUR HERE!**



### **PHARMACY TOUR HERE!**



#### ***Reasons for the project:***

- Identified a need to ensure the environment matched the care our patient received. Bright and roomy areas with a choice of privacy will create a personalized healing environment for the patient and family.
- The current space was failing. The temperature of the unit was difficult to manage, making temperature control for the patients difficult fluctuating from hot to cold depending upon the weather outside.
- There was a need to address pharmacy standards that had changed and the current location was not conducive to ensure we were in compliance with the new pharmacy standards.
- COVID brought forth facts that the current area is not able to fully support infection control measures.
- Our unit is small, and the number of patients needed to receive care, close to home, is growing. Unfortunately, this caused some community members to have to travel to London to receive their treatment.

#### ***What we look forward to:***

- New, bright with natural light, and roomy environment that will increase our care capacity.
- Co-located pharmacy and chemo treatment unit to ensure we are in compliance with pharmacy standards.
- The ability to care for patients in a negative pressure sterile environment, when required.
- Improved communication and an increase in privacy
- The Co-located pharmacy will allow us to administer medications in a timely fashion, ensuring our patient receives the best care possible.

## **HELP GIVE CANCER A KNOCK-OUT PUNCH!**



**We need you in our corner to help give cancer a knock-out punch today. Your donation supports our new cancer care/chemotherapy unit and essential medical equipment throughout our hospital that can help detect, diagnose and defeat cancer right here where we live. Don't delay, your generosity can help save a life today!**





# Did YOU Know?

## 2022/23 at Stratford General

- 1,124 babies were delivered
- 61 babies were treated in the Special Care Nursery
- 32,291 patients were seen in the Emergency Department
- 2,083 inpatient surgeries and 8,919 day surgeries were performed
- 459 children were treated on the Pediatric Floor
- 527 Mental Health inpatients were cared for
- 831 Patients treated in ICU & Telemetry Unit
- 26,649 X-Rays were taken and 16,071 CT Scans were performed
- 18,267 Ultrasound Exams, 3,079 Nuclear Medicine Exams and 1,469 Echo Cardio Exams were performed
- 7,345 Mammography Exams and 3,462 Ontario Breast Screening Program (OBSP) exams were performed
- 4,554 MRI scans were performed
- 3,337 Dialysis Visits
- 2,298 Oncology Visits (Chemo Only)

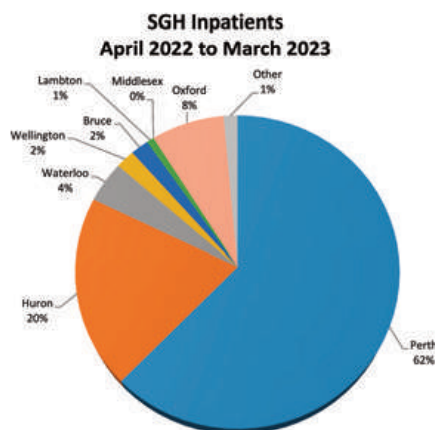

## 2022/23 Throughout HPHA's 4 sites (Stratford, St. Marys, Seaforth, Clinton)

• Babies Delivered .....	1,124
• Patient Days .....	57,046
• Inpatient Surgeries Performed .....	2,083
• Day Surgeries Performed .....	10,391



### Hemoglobin

HPHA labs analyze 13,000 glycosylated hemoglobin (HbA1C) specimens to diagnose and monitor diabetes and examine 5,300 throat cultures for Strep A, the pathogen that causes strep throat on an annual basis



### Lab Cancer

Our lab views 32,000 tissue specimens for cancer on an annual basis

### Stratford General:

- Secondary Care Centre
- Schedule 1 Mental Health Facility
- Regional Stroke Centre
- Major training site for Schulich/Western
- Internal Medicine, General Surgery, Urology, Orthopedics, Psychiatry, Otolaryngology, Obstetrics, Gynecology, Paediatrics, Pathology, Anesthesia, Emergency, Family Medicine, Ophthalmology and Radiology
- ✓ Top Performer in the Province MRI Access
- ✓ Top 5 Performer in the Province CT Access
- ✓ Emergency Wait Times Exceed Provincial Targets
- ✓ Significant Improvements in Access to Hip and Knee Replacements
- ✓ National Leader in Patient and Caregiver Engagement



# Making A Real Impact . . . A Salute

*Each donation is precious, and every donor is priceless...individuals, groups,*



## WINDMILL GARDENS *Prescription for Care*

A Salute to the Board of Directors, Windmill Gardens for their generous gift of \$2 Million to name the new pharmacy unit and 5 portable ultrasound machines for Stratford General Hospital. It is an honour and privilege to ensure their lasting legacy has an impact on patients, families, and our hospital team for decades to come. We can never say thank you enough!



## South Easthope Mutual Insurance Tavistock

The employees of South Easthope Mutual Insurance Company recently made a donation of \$1,000 to the Stratford General Hospital Foundation's "In Our Hands" Capital Campaign. Employees raised the funds through bake & craft sales, raffles and their Dress Down Friday program. Employees select charities to receive donations each year.

In the photo, Cheryl Hunt, Community Giving Manager of the Stratford General Hospital Foundation (centre) accepts a cheque from South Easthope Mutual employees, Marianne Ruby (left) and Kara Cahill (right).



## Optimist Club of Shakespeare

A heartfelt thank you to the members of the Optimist Club of Shakespeare who have generously donated \$10,000 in support of the In Our Hands campaign- Maternal Child Unit. With the dedication of caring community members- The Future is #InOurHands!

L-R: Michael McNeil- President, Optimist Club of Shakespeare, Cheryl Hunt- Executive Director, SGH Foundation, Jean Smelski- member of both the Optimist Club of Shakespeare & the SGH Foundation Board of Trustees. Not Pictured- Gary West.



## Festival Hydro - "Go Paperless" campaign

Thank you to Festival Hydro and their thoughtful customers who took the pledge to "Go Paperless". This fundraising effort generated an incredible \$5000 in support of an Infant Bassinet for the Mat/Child unit at SGH. We can never say thank you enough!



## TRADITION MUTUAL STEPS UP TO SUPPORT NICU'S URGENT CASE FOR SUPPORT!

Thank you to our caring community members at Tradition Mutual Insurance Co.(Sebringville) who answered our urgent appeal- donating an incredible \$55,070 to support (2) C1 Hamilton ventilators for our tiniest patients!



## Royal Canadian Legion - Branch 532 New Hamburg

L-R: Andrea Page, (outgoing ED- SGHF) and Cheryl Hunt, newly appointed Executive Director- SGH Foundation, Margret Nodwell and Ross Eichler of RCL Br 532.

Our gratitude to the Royal Canadian Legion- Branch 532 of New Hamburg: Branch 532 donates \$2,800 from their Poppy Fund in support of Ultrasound Machines for SGH. It was lovely to celebrate this gift with you on a sunny day!



# to Our Community's Generosity!

and businesses building a brighter future for healthcare throughout our region.



## HYDE CONSTRUCTION LIMITED

Thank you to Hyde Construction Limited who have generously donated \$35,000 to name "Chemotherapy Unit Treatment Room #1" in our New Cancer Care & Ambulatory Medical Clinic ...

What a special way to celebrate 35 accomplished years in business. Congratulations for all your hard work in our communities!

Chemotherapy Unit Treatment Room #1: provides a relaxing and private environment for our Cancer Patients who require a separate room for treatment. This room is designed with bright, natural lighting, with an abundance of space focused on patient experience while still providing a safe environment for our medical team to provide care.

*We can never say thank you enough for your support!*

[www.InOurHands.ca](http://www.InOurHands.ca)

## Royal Canadian Legion Branch 8 - Poppy Fund

We sincerely thank RCL Branch 8 who have generously donated \$10,000 (through their Poppy Fund) to fund a Chemo Bay in our new Cancer Care & Ambulatory Medical Clinic.

Your continued support is truly touching, and has tremendous impact in the comfort and patient care of our community members- many of them Veterans. *Thank you so much!*

L-R: Ken Albert, Tom Sauper, Dale Bast, Steve Zurbrigg, Mary Helen McIntosh, Phil Rader, Linda Hunter, Cheryl Hunt- ED, SGHF, Anne Boyd, Doreen Zurbrigg, Bob Wickenheiser, Heather Wickenheiser and Jim Collins.



40 years

Stratford General Hospital Foundation celebrated 40 years of caring with a party on August 1 2023 - it was a pleasure to celebrate with staff, donors, family and friends!



# Making A Real Impact . . . A Salute

*Each donation is precious, and every donor is priceless...individuals, groups,*



## CELEBRATING OUR "QUEEN BEE" ANDREA PAGE RETIRES AFTER 30 YEARS OF LEADERSHIP AT SGHF



*While it's too difficult to summarize her accomplished tenure...*

We'd like to thank Andrea Page for her extraordinary leadership, wisdom, generosity, and grace at the helm of the Stratford General Hospital Foundation.

We wish you a healthy and fun-filled retirement.

***You deserve it!***

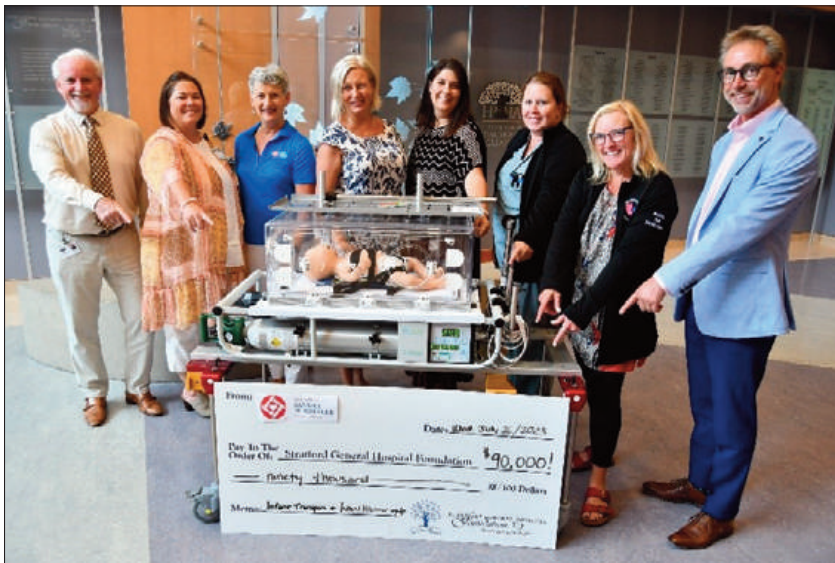

### SANDRA SCHMIRLER FOUNDATION

The Stratford General Hospital Foundation is the lucky recipient of a \$90,000 grant from the Sandra Schmirler Foundation in support of an Infant Transport and an Infant Warmer for our Special Care Nursery in our Maternal Child Unit.

The Infant Transport is an essential and state-of-the-art piece that will allow our medical professionals to safely and securely transport our most vulnerable tiny humans to a partnering Neonatal Intensive Care Unit in the event the little ones' condition worsens.

The Infant Warmer is designed to simultaneously provide external heat and open access to the newborn for ease of monitoring, necessary procedures, and resuscitation to be performed instantaneously.

Sandra Schmirler is a curling legend, a three-time Canadian and World Curling Champion, and an Olympic gold medalist. She was also a loving mother to two baby girls who were Sandra's greatest joy. Although cancer tragically took Sandra's life in 2000 at the age of 36, her skill, determination, and resilience on the ice ensure that her name will live on in the curling record books forever. The Sandra Schmirler Foundation is a Canadian Foundation focused on supporting hospitals across Canada with the purchase of life-saving equipment for premature and critically ill babies, giving them a chance to grow up to be champions like Sandra!

Thank you, Sandra Schmirler Foundation, for joining our strong and committed community of supporters. Through your generosity, our community will have access to a safe and supportive environment with life-saving equipment for our tiniest champions!

***We can never say thank you enough!***

Photo L-R: Andrew Williams- President and CEO, HPHA, Cheryl Hunt- Community Giving Manager, SGHF, Julie McMullin- Board Director, Sandra Schmirler Foundation, Barb Thibeault, Board Chair-SGHF, Lynanne Mason- Vice President Partnerships & Chief Nursing Executive, HPHA, Sheila Bell, RN, Team Lead, Maternal Child Unit SGH, Audra Boersen, Reg. N. Manager, Maternal Child Unit and Scheduling Office, SGH, Rick Orr, In Our Hands Campaign Co-Chair and SGHF Board Member.



# to Our Community's Generosity!

*and businesses building a brighter future for healthcare throughout our region.*



## **Re/Max A-B Realty Ltd. Gift Pledge of \$200,000**

We'd like to recognize the fabulous team members of RE/MAX a-b Realty Ltd. for pledging \$200,000 towards the Communication Station in our Cancer Care and Ambulatory Medical Clinic. Your investment in patient care brings new possibilities closer to home! On behalf of our patients, their families, and hardworking caregivers - we can never say thank you enough!



## **Re/Max A-B Realty Golf 2023**

Thank you to incredible community members and generous business owners who made our annual RE/MAX a-b Realty Ltd. Charity Golf Tournament in support of the NEW Cancer Care and Ambulatory Medical Clinic at SGH a success... \$30,000 was fundraised from this event!





# *The magic of giving... is In Our Hands*



This holiday season, we are focused on how magical a gift truly can be and how impactful it will be for our new Cancer Care and Ambulatory Clinic as well as the Co-located Pharmacy program.

Did you know our Chemotherapy Unit opened in November 2002 in the middle of a snowstorm? When you speak to people who remember this day, they all recall the snowstorm - and how it emphasized the importance of having this care, right here at home, within the Stratford General Hospital!

21 years later, our hospital continues to provide supportive, healing, and nurturing care to our cancer patients, ensuring their journey is as pleasant and as stress-free as possible.

Annually, our Chemotherapy Unit supports over 2100 patients and these numbers keep growing!

Excellent care would not be possible without our dedicated Pharmacy Team. This team works closely with the Cancer Care program, and it also provides all pharmaceutical needs to each site within the Huron Perth Healthcare Alliance as well as the Alexandra Marine & General Hospital in Goderich.

The need for a new Cancer Care and Pharmacy Unit has been recognized through careful consideration and in consultations with key stakeholders. The hospital has embarked on this expedition to enhance our patients' cancer care experience and to ensure the hospital has a unit that will

meet our current and future needs. A unit that will be better equipped to provide safe care to our patients who are immunocompromised, and will allow for more patients to receive treatment closer to home.

The new unit is slated to be treating patients by the Summer of 2024 and is an \$18-million-dollar investment. Every piece of equipment within our hospital is here because our community cares! Without your support, our hospital would not have the tools it needs to provide the care our community deserves. The reason for this is simple.... the government does not provide funding for new or replacement equipment that a hospital and its patients need.

This makes our In Our Hands Capital Campaign even more significant! Our community has been very generous. Our healthcare heroes feel the love from the community every time they are being trained on new equipment or are supporting a patient in a newly remodeled environment – they are touched by how much our community cares!

Our ask of you for this holiday season: ... let's all join together for our Cancer Care and Ambulatory Clinic and Co-located Pharmacy team to show them we care! Let's show our hospital what the magic of giving can do!

Please watch our short video summarizing the importance of healthcare being in our hands at [www.inourhands.ca](http://www.inourhands.ca)



## **Lasting Legacy** *the Promise* **of Tomorrow**

*Ordinary people show extraordinary generosity by leaving legacy gifts to our hospital in their wills*



STRATFORD GENERAL HOSPITAL  
*Foundation*  
"People Caring for People"

SGHFOUNDATION.ORG  
519.272.8210 ext. 2626



# We Can Never Say Thank You Enough to Our Donors



## Our Donors Have Real Impact

The SGH Foundation Board Members send their heartfelt thanks to our wonderful donors...  
*We couldn't do it without your generosity!*

### 2022/2023 EQUIPMENT PURCHASES

The Stratford General Hospital Foundation disbursed **\$1,022,369.39** to the hospital.

*The items sponsored through our donors' generosity include:*

#### CAPITAL DISBURSEMENTS - DONOR ALLOCATED - 2022/2023 DISBURSEMENTS - "In Our Hands" Equipment Campaign

Chemotherapy	Scale - Wheelchair Digital Ramp Healthometer	\$2,608.95
Emergency	Scale - Wheelchair Digital Ramp Healthometer	\$2,560.56
Emergency	Portable Doppler	\$1,119.39
Emergency	Glidescope (50% First Payment)	\$11,323.37
Holter	Holter Recorders	\$5,435.55
ICU	Glidescope (50% First Payment)	\$11,113.32
Laboratory	Centrifuge - Cytospin Rotofix	\$9,131.85
Laboratory	Anaerobic Chamber	\$22,722.54
Laboratory	Incubator - Bactex FXS-Top Blood Culture Unit	\$41,418.31
Laboratory	Refrigerators - Laboratory Grade	\$11,588.89
Laboratory	Freezer - Laboratory Grade	\$7,187.59
Laboratory	Tilt Telescope	\$3,737.33
Laboratory	Autocut - Histocore Autocut w/ Foot Switch	\$32,510.86
Laboratory	Incubator - Pro Series Countertop	\$28,173.30
Laboratory	Centrifuge - Sorvall	\$10,279.21
Laboratory	Thermo SCI CO2 Incubator	\$12,985.89
Laboratory	Refrigerator	\$9,109.27
Laboratory	Processors - Tissue (20% Fourth Payment)	\$26,153.00
Mammography	PACS/Mammo Monitors	\$108,823.24
Maternal Child	Warmers - Panda Infant Warmers (Fourth Partial Payment)	\$108,163.39
Maternal Child	Incubators - Giraffe Carestation Incubator	\$35,016.71
Medical Imaging	Digital Xray Unit (10% First Payment)	\$36,091.25
Medical Imaging	Imagine Suite (20% Fifth & Final Payment)	\$91,510.19
Medical Imaging	Digital Mobile Standard C-arm (Third Payment)	\$26,491.42
Medical Imaging	Fluoroscopy System (Second Payment)	\$95,834.14
Medical Imaging	Mammography (Second Payment)	\$27,795.29
Mental Health	Intercom for Mental Health Safe Rooms	\$5,196.40
Mental Health	Intercom for Emergency Safe Room	\$2,343.47
Pharmacy	Refrigerator - Pharmacy Grade	\$9,071.78
Rehab	Sara Steady Transfer Aid	\$1,799.28
Rehab	Treadmill	\$5,738.98
Rehab	Recumbent Bike	\$2,542.16
Stroke	Roll In Shower Chairs	\$2,255.00
Surgical Services	Beds - Centrella	\$170,000.00
Telemetry	Monitors - Welch Allyn Connex Spot Monitors	\$7,935.96
Volunteer Services	Freezer - True Undercounter	\$4,382.37
Volunteer Services	Cash Registers - 2	\$2,219.18
Education	Elsie - Year 4	(\$31,121.61)
West Building Annex	\$ 30,000.00	
<b>Disbursement Cheque Amount</b>		<b>\$ 1,022,369.39</b>

### Our 2023-2024 SGH Foundation Board of Trustees

**Back Row, L-R:** Matt Rees, Josef Frank (Vice-Chairman), Barb Thibeault (Board Chair), Rick Orr (IOH Campaign Co-Chair), Robert Gould, Paul Roulston (IOH Campaign Co-Chair), and Hugh McDonald.  
**Front Row, L-R:** Cheryl Hunt (Executive Director), Fritz Steigmeier, Alyson Conrad, Phil Buxton (Treasurer), and Jean Smelski.  
**Absent:** Mayor Martin Ritsma, Andrew Williams, and Colleen Misener (Honourary).



# VOLUNTEERS OF STRATFORD GENERAL HOSPITAL



As a sense of normalcy returns to the hospital, existing and new volunteers are keen to support the re-engagement of programming, including Volunteers in the Emergency Department and Inpatient Units. Once again, our team has begun to flourish as we welcome back familiar faces and diversify our volunteer complement. The changing fundraising landscape brings an opportunity for our Special Events Committee to take innovative approaches to fundraising and the Coffee/Gift Shops continue to offer a selection of goods, focusing on seasonal and artisanal products.

Volunteers are an extension of the HPHA Family providing non-medical support to both patients and staff. This is paramount in the Emergency Department (ED) where energy runs high, demanding a lot from staff. ED volunteers warmly greet arrivals; offering assistance as needed, ensuring an individualized compassionate patient-centred experience. Volunteers minimize patient/caregiver stress, acting as the liaison between patients, visitors, and staff. Through supporting staff and ensuring patient comfort measures are met, we create a quality experience within the emergency department. This extends to our inpatient unit, where patients and volunteers establish a long-term therapeutic relationship through recreational activities. We welcome you to consider joining our fleet of volunteers supporting the ED and Inpatient Units.

Between outpatient clinics and the return of caregivers and visitors, we recognize the important role volunteers have, acting as ambassadors for the HPHA, and catering to the unique needs of our communities. Our patient population continues to change requiring a diverse volunteer roster that is able to adapt and respond to unique patient needs. Whether it be wayfinding, providing comfort measures, or participating in recreational activities volunteers provide reassurance in otherwise sensitive times. We recognize that not all patients are the same, it is important that our volunteer base reflect the different demographics we serve. There has been an increase amongst youth volunteers, resulting from our high school student engagement. In response, we have changed our policy, encouraging students over the age of 16 to apply.

## Christmas in July Raffle

Our Special Event Committee launched its first 'Christmas in July Raffle,' a tropical Christmas raffle with 10 prizes of \$250.00, 1 prize of \$1000.00 and a grand prize of \$2500.00. Five hundred tickets were sold by volunteers onsite at Stratford General Hospital, at Sobeys grocery store, and at Stratford Farmer's Market. We successfully raised \$6,500.00 with 100 percent of the funds raised going towards much-needed equipment. Through generous donations of books from staff, volunteers, and our community we have raised over \$6,000.00 from our book sale. This by-donation fundraiser engages our hospital community in the front lobby and has been running for six months. We are accepting book donations on an ongoing basis at the SGH Information Desk.



*Congrats to Stephanie S for winning the grand prize draw of \$2500.00!*

***Thanks to all our participants  
for supporting equipment needs  
of Stratford General Hospital.***





The Coffee and Gift shops are owned and operated by the Volunteers of Stratford General Hospital. We are committed to aligning ourselves with the HPHA's Diversity Equity Inclusion and Anti-Racism committee to build awareness, selling goods and celebrating Mental Health Awareness Month, Black History Month, and Pride Month. October is Breast Cancer Awareness Month. In the Gift Shop, we will be focussing on thriving and not just surviving, featuring local, handmade, all-natural, and vegan bath and body products. Products are sourced, focussing on Canadian-made, Women, BIPOC, and 2SLGBTQIA+ owned businesses. One hundred percent of profits goes toward the purchase of state-of-the-art, hospital equipment. We have made an \$85,000 commitment to the new Chemotherapy Unit. We have successfully reached 85 percent of our goal, with \$72,000 raised to date.

*Sincerely, The Volunteers of Stratford General Hospital*







## Cheryl's Corner

It is such an honour to support our Stratford General Hospital Foundation. The Foundation has deep roots in our community and over the past 40 years has successfully ensured our community's donations have made a real impact within our hospital. As I ponder how I have been so blessed to be in the role that I am, I wish to share my story of how my passion for philanthropy has come to fruition.

My interest in charity started at a very young age with small school projects such as Jump Rope for Heart in support of the Heart and Stroke Foundation – my focus was on raising money and working hard to ensure I was one of the last ones jumping at the end of the event! I think back on those days now and say – wow what I would not give to have that energy again! I also recall my passion for wearing a little orange box around my neck at Halloween to collect coins for Unicef. I would often ask for two boxes as I was committed to ensuring I filled both boxes for their worthwhile cause. Reflecting back, the stories surrounding how “little me” could choose to make a difference have enchanted me. Who knew at such a young age you could make a difference in our society?

Fast forward to years later, my interest in supporting our community through various charitable opportunities continued to be of inspiration. My passion grew stronger as I witnessed firsthand the importance of giving of yourself for the betterment of others. Prior to joining the SGH Foundation team over one year ago, I was fortunate to be the Corporate Lead Volunteer Services within the Huron Perth Healthcare Alliance for over 11 years. During this time, I learned from a variety of individuals about the importance of giving. Giving of their time, their talents, and their treasures all had merit and were impactful. Through these dedicated community members, I learned that each one of them had a story to share, a reason to give back, and a reason to make a difference. These stories lifted me up,



*This photo is from September 2017 in support of the Volunteers of SGH Book Launch Fundraiser  
l-r: Andrew Williams, President & CEO, Cheryl and Lisa, Volunteers of SGH, Cheryl Hunt, Corporate Lead Volunteer Services, Andrea Page, ED SGH Foundation.*

brightened my spirit, and touched my heart. The magnificent impact these individuals made each and every day to ensure our patients, family, and community had the best possible hospital experience is commendable. These relationships and experiences led me to a deeper understanding of the impact giving has on our community. Having worked closely with all the Foundations supporting the HPHA, I was able to graciously observe the tremendous impact the Foundations have through opening doors and providing opportunities for our community to support their hospital through fund-raised dollars. These impactful experiences inspired me to pursue a fundraising role within our SGH Foundation. If I can be a part of the system that encourages the art of philanthropy through community engagement for the betterment of our hospital, my soul will be happy.

One thing that I have learned is that philanthropy is more than just giving; it is a reflection of our shared commitment to making our community a better place for all. It's about recognizing our responsibility to uplift one another, to bridge the gaps that exist, and to ensure that no one is left behind.

As we navigate the challenges of our time, humanitarianism remains a powerful tool for positive change. Whether it's donating to a local charity, volunteering your time, or sharing your expertise, each act of generosity contributes to the betterment of our community.

I encourage each and every one of us to consider how we can play a part in supporting our community through philanthropy. Together, we can build a stronger, more resilient, and compassionate community that benefits us all.

I look forward to supporting you with your philanthropic journey and thank you for your continued commitment to making our hospital a better place for everyone. Your kindness and generosity are the cornerstones of our shared success.

## ELIMINATE YOUR CAPITAL GAINS TAX

*Consider a gift of listed securities to the  
Stratford General Hospital Foundation*

The Federal Government has eliminated capital gains tax on appreciated listed securities when they are donated to charity. This results in a double tax benefit for donors.

By transferring the security directly to the Foundation, donors can eliminate all capital gains tax on their gift. Furthermore, the Foundation can provide a charitable receipt for the full 100% of the fair market value.

*Please contact us for more information*  
519-272-8210 ext. 2627  
andrea.page@hpha.ca



STRATFORD GENERAL HOSPITAL  
*Foundation*   
"People Caring for People"



## Donations in Honour of and in Memory of ...

The Stratford General Hospital Foundation is grateful to the family members and friends who have made Honour and Memorial donations from May 1, 2023 to September 30, 2023.

### In Honour of

Eleanor Bohnert  
Earl Clark  
Ken & Pat Eidt  
HPHA Board of Directors  
Mark Hunter  
Patricia Million  
Donna Ogilvie  
Christine Ricottone  
Oscar Smith  
Keith Thompson

William "Bear" Chambers  
John "Jack" Chipka  
Ken Connolly  
Elinor Cook  
Shirley Cooke  
Mary Lynn Core  
Mirella Costanzo  
Austin Cuerden  
Marion Davis  
Maurice Peacock Dean  
Scott Diamond  
Baby Hazel Drew Diehl

William Lindner  
Anne Martens  
Robert Martin  
Gwendolynn Matthison  
Rosemary McArthur  
Barry McCarthy  
Henry "Harry" McCarthy  
Alexander McDonald  
Don McLeod  
Gordon "Gordie" Merkel  
John Moore  
James Robert Moore

George Roulston  
Ruth Roulston  
Lorne Ruller  
William Russell  
Noelle Elizabeth Saville  
Paul H. Schlegel  
Julie Schnell  
Jean Schultz  
Corrie Segeren  
Chris Sellner  
Jim Smellie  
Dorothy Smith

### In Memory of

Jack Armstrong  
Marion Patricia Atherton  
Ralph Bender  
Clara Black  
Richard Blackburn  
Marion Blue  
Henricus "Henk" Boersen  
Donald Bowman  
David "Louie" Boyd  
Audrey Boyd  
Robert Brodhagen  
Robert Brodrecht  
Grant Andrew Buxton  
Lynn Buxton  
Richard Carter

Meagan Ellis  
Elmer Gordner  
Ruth Pearl Gransden  
Wilf & Ann Gregory  
Tillman Hartman  
Doug Haslam  
Sylvia Helperin  
Elsie Alvertta Henderson  
Bill Hildenbrand  
Elizabeth "Liz" Horne  
Margaret "Marnie" Horwood  
John Howatt  
Paul Jackson  
Priscilla Johnson  
Ralph Kropf  
Keith Kunder

Gerald Moorehead  
Gail Nixon  
Barry Nowack  
Patte Parker  
G. Ross Parker  
Janice Parker  
Mark Gordon "Philly"  
Phillips  
Phanomphone "Tounny"  
Phimsavanh  
Francis Price  
Linda Rau  
Glenn Richards  
Wendy Rider  
Audrey Riedel  
June Riehl

Julie Schnell  
Jean Schultz  
Corrie Segeren  
Chris Sellner  
Jim Smellie  
Dorothy Smith  
Alex Smith  
Joso Tomasevic  
John Treble  
Nick Tsaltas  
Lorena (Rena) Tuer  
Nellie Vanderhyden  
Joan Veldman  
Cheryl Verellen  
Lianne Vink  
David Vollmer  
James Walker  
Douglas Wettlaufer  
Baby Jaxx Wreford  
Sherry Yundt  
Robert Yundt

## YOUR DONATION COUNTS!

Please take a moment and reflect on what our community would be like without our hospital. Our health care team has one main focus - YOU - the patient. In the last year the health care team has touched the lives of countless people and their families with their compassion, skill and expertise. Every gift you give impacts the care we are able to provide. Your support purchases essential medical equipment - equipment we can't afford to be without. We count on you to help us provide quality and patient-focused care. Thank you!



YES, I care!

I wish to support our Hospital.



Name: \_\_\_\_\_ Address: \_\_\_\_\_

City: \_\_\_\_\_ Postal Code: \_\_\_\_\_ Telephone: \_\_\_\_\_

☐ Enclosed is my cheque to Stratford General Hospital Foundation. Email: \_\_\_\_\_

☐ \$1,000 ☐ \$500 ☐ \$250 ☐ \$100 ☐ \$50 ☐ \$25 I prefer to give \$ \_\_\_\_\_

☐ ☐ ☐ Card # \_\_\_\_\_ Expiry Date \_\_\_\_\_

☐ I'd like to pledge my support of \$ \_\_\_\_\_ each year over the next \_\_\_\_\_ years.

Signature \_\_\_\_\_ Date \_\_\_\_\_

A receipt will be issued for tax purposes. Charitable Registration # BN 11920 0004 RR0001

Our donor records are confidential. We do not share our lists.

Thank you for caring!





## It's In Our Hands...Without you we have nothing

Every piece of patient care equipment is at our hospital because donors cared.

The Stratford General Hospital Foundation's "In Our Hands" Capital Campaign has a goal of \$30 Million.

There is an extensive list of equipment needed for Stratford General Hospital, and some top priorities include:

- Chemotherapy and co-located Pharmacy Renovation
- NEW Fluoroscopy and Mammography Units
- Mental Health Initiatives
- New Lab & Technology
- New beds throughout the hospital
- Operating Room Equipment

Speak with one of our team to learn more:

[sgf.foundation@hpha.ca](mailto:sgf.foundation@hpha.ca)

519-272-8210 ext 2626

### SGH FOUNDATION MONITOR...

is published for the information of our donors, supporters and friends of the SGH Foundation.

#### STRATFORD GENERAL HOSPITAL FOUNDATION

46 General Hospital Drive, Stratford, ON N5A 2Y6

*The SGH Foundation works with the community to help raise funds for equipment, upgrading of facilities and special projects of the Stratford General Hospital.*



Readers will note a change to coated paper,  
which is the same cost and allows clearer pictures.  
Contains recycled fibre and is recyclable.

Charitable Reg. BN 11920 0004 RR0001



Stratford General Hospital Foundation  
46 General Hospital Drive  
Stratford, Ontario N5A 2Y6

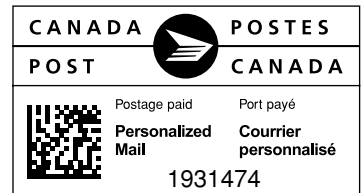

RETURN POSTAGE GUARANTEED  
PORT DE RETOUR GARANTI

STRATFORD GENERAL HOSPITAL  
*Foundation*

"People Caring for People"



SGHFOUNDATION.ORG | 519.272.8210 EXT. 2626